

- 1
- 2
- 3
- 4
- 5
- 6
- 7
- 8
- 9
- 10
- 11
- 12
- 13
- 14
- 15
- 16
- 17
- 18

MATERIAL

Aluminium, epoxy resin coating, RAL 9005 black colour, matte finish.
AISI 304 stainless steel screws and nuts.

STANDARD EXECUTIONS

- **GN 163.1-B**: without sliding bushings.
- **GN 163.1-G**: with polyamide based (PA) or polytetrafluoroethylene based (PTFE) technopolymer sliding bushing.

FEATURES AND APPLICATIONS

GN 163.1 bases can normally be matched with the linear actuators. The additionally provided mounting holes are used to connect to the drive key of a linear actuator. The hole identified as G is provided with sliding bushings
By clamping the guide hole d1 it is possible to adjust the actuator positioning and to lock the slider after having set up the final position.

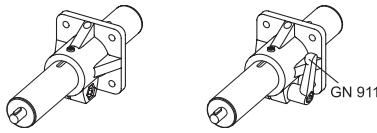

Conversion Table	
1 mm = 0.039 inch	
d1	
mm	inch
30	1.17
40	1.56
50	1.95
60	2.34

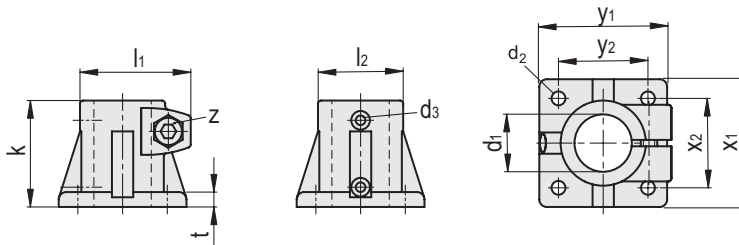

GN 163.1-B

METRIC

Code	Description	d1 Bore without sleeve bearing	d2	d3	k	l1	l2	t	z	x1	x2	y1	y2	△
GN.48706	GN 163.1-B30-50-2-SW	30	6.5	M4	50	52	40	7	M8-25	60	42	60	42	145
GN.48707	GN 163.1-B30-70-2-SW	30	8.5	M4	70	68	56	10	M10-35	90	64	90	64	430
GN.48716	GN 163.1-B40-70-2-SW	40	8.5	M5	70	68	56	10	M10-35	90	64	90	64	430
GN.48717	GN 163.1-B40-85-2-SW	40	11	M5	85	77.5	65	14	M10-50	105	74	105	74	711
GN.48726	GN 163.1-B50-85-2-SW	50	11	M6	85	77.5	65	14	M10-50	105	74	105	74	711
GN.48736	GN 163.1-B60-100-2-SW	60	11	M8	100	92	80	14	M10-50	125	89	125	89	1020

GN 163.1-G

Code	Description	d1 Bore with sleeve bearing	d2	d3	k	l1	l2	t	z	x1	x2	y1	y2	△
GN.48806	GN 163.1-G30-50-2-SW	30	6.5	M4	50	52	40	7	M8-25	60	42	60	42	130
GN.48807	GN 163.1-G30-70-2-SW	30	8.5	M4	70	68	56	10	M10-35	90	64	90	64	400
GN.48816	GN 163.1-G40-70-2-SW	40	8.5	M5	70	68	56	10	M10-35	90	64	90	64	400
GN.48817	GN 163.1-G40-85-2-SW	40	11	M5	85	77.5	65	14	M10-50	105	74	105	74	650
GN.48826	GN 163.1-G50-85-2-SW	50	11	M6	85	77.5	65	14	M10-50	105	74	105	74	650
GN.48836	GN 163.1-G60-100-2-SW	60	11	M8	100	92	80	14	M10-50	125	89	125	89	1020

Tube connectors